

SERIES

Smart.

Soft.

Simple.

Value
Creating
Partner

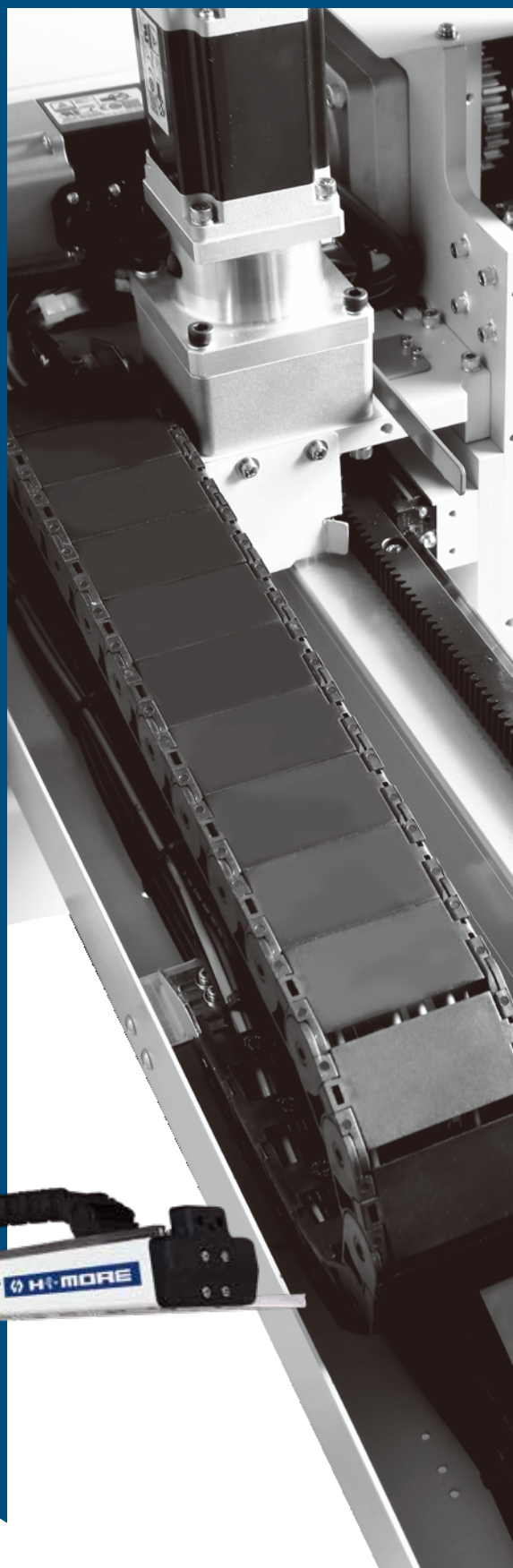



In view of changes in structural design, light appearance design ST series nearly reduces 20KG in comparison with that of THS series in the past and reduce nearly 10KG in comparison with that of HX series. This optimization will greatly reduce the burden of motor and increase the efficacy of its service life

Smart.
Soft.
Simple.

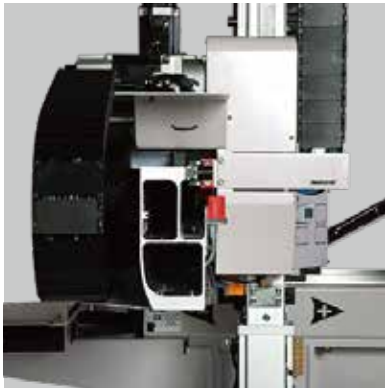

Consideration of vibration control 1.
— front and rear mechanism

Reduce the burden of horizontal device to effectively extend the service life of motor



Consideration of vibration control 2.
— Up-and-down mechanism

Elongate up-and-down fixed position of sliding block in comparison with that of HX series, Extend from the original 182mm to 274mm that increases machine stiffness

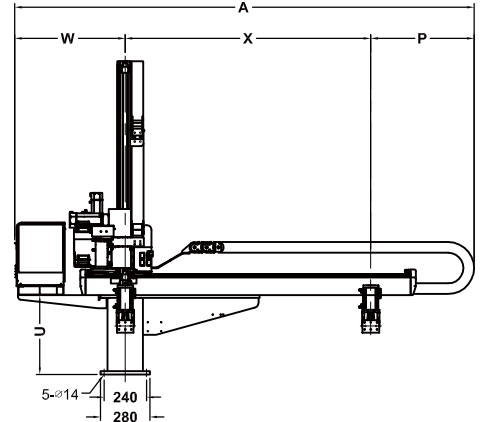

Light weight of wings -
reduce the load

Reduction of the burden of horizontal device will effectively extend the service life of motor

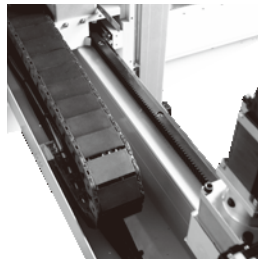

Rear axis rack driving -
increase stiffness

Dual complementary up-and-down linear guideway makes



High-efficiency and high-stiffness
rack driving mechanism is more stable

Changes in the position of vacuum pressure position. Regulatory position can reduce the light reflection of viewable area display

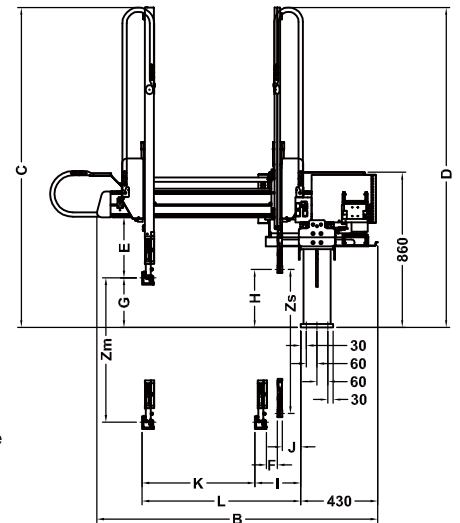

Model	A	B	C	D	E	F	G	H	I	J	K	L	P	X	U	W	ZM	ZS
STIII 800	2605 (2815)			X		X		X	120	X	750			1350 (1560)				X
STV 800	(3065) (3245)	1560	1775		335	60	275	322	255	105	615	870	585	(1810) (1990)	450	670	800	850
STIII 900	2815 (3065)			X		X		X	120	X	750			1560 (1810)				X
STV 900	(3245)		1895		60			322	255	105	615			(1990)			900	950

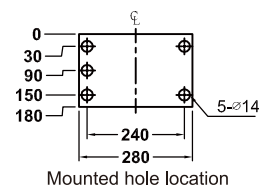

Mounted hole location

Model	IMM (TON)	Payload	Wrist rotation	Compressor Air Consumption	Voltage	Air Consumption	Input Power
STIII-800						1.08 Nl/Cycle	1.6KW
STV-800						1.15 Nl/Cycle	2.4KW
STIII-900	300 or less	5KG (With jig)	90°	0.5MPa	AC220V±10% (50/60HZ)	1.08 Nl/Cycle	1.6KW
STV-900						1.15 Nl/Cycle	2.4KW

Combine with wire distribution cabinet perfectly To continue to improve the product, just reserve the rights to change all machinery design and specifications. Design and specifications are subject to change without prior notice.

() Traverse stroke extends the specifications optional end support frame

III type: Three-axis AC servo driving series (main arm/up-and-down/peeling/traverse type)

V type: Five-axis AC servo driving series (main arm/sub-arm/up-and-down/peeling/traverse type)

Overall cycle time : 6 sec
Take-out cycle time:1.3 sec

Easily introduce cloud management
connected industry 4.0 IoT



Hi-More Robot Co.,Ltd.

T +886-3-381-1614 E-Mail sales@hi-more.com

A No.1,Ln 15, Neiding 20th St., Zhongli Dist.,Taoyuan City 320, Taiwan R.O.C.

